

HANDLE SECTIONS

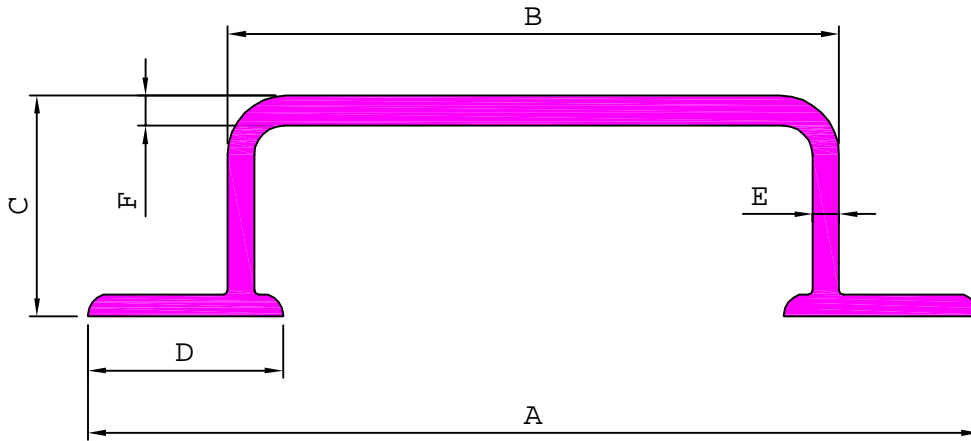

SL. No.	Section No.	A	B	C	D	E	F	Weight kg/m
1	18593	98.00	62.00	24.00	24.00	2.37	2.37	0.875
2	18685	100.00	69.00	28.00	21.80	2.50	2.80	1.030
3	18686	119.50	81.00	29.50	25.25	2.00	2.10	0.939
4	18661	122.00	80.50	29.00	27.00	2.80	2.80	1.248
5	18655	123.00	83.50	31.00	26.50	3.70	3.70	1.659
6	18662	142.00	97.00	29.50	30.00	3.00	3.00	1.476
7	18654	147.00	107.50	31.00	26.50	3.70	3.70	1.899
8	18586	148.80	106.50	33.00	27.30	3.90	4.20	2.105
9	18619	150.00	110.00	34.00	30.00	3.45	3.60	1.995
10	18572	150.00	110.00	34.00	30.00	3.66	3.66	2.127
11	18620	150.00	110.00	34.00	30.00	4.00	4.10	2.248

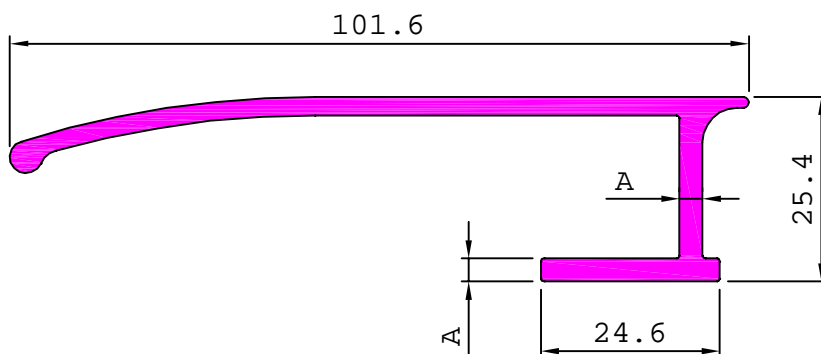

SL. No.	Section No.	A	Weight kg/m
1	18553	3.18	1.093
2	18604	2.10	0.852

HANDLE SECTIONS

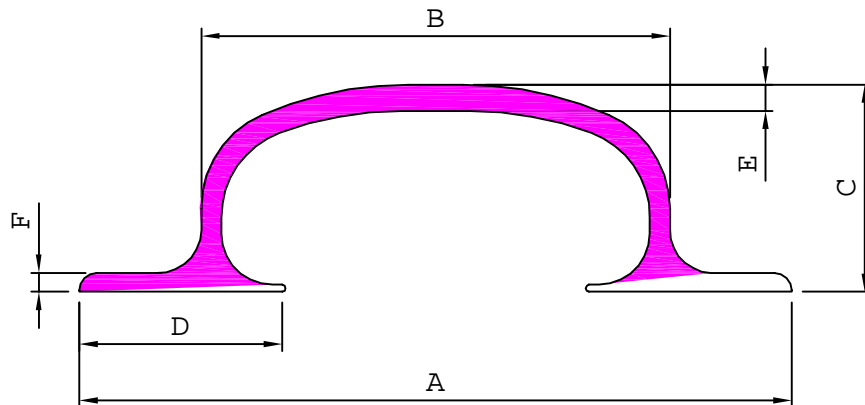

SL. No.	Section No.	A	B	C	D	E	F	Weight kg/m
1	18675	100.60	65.50	28.00	25.00	2.00	1.55	0.797
2	18660	101.00	65.30	28.10	28.00	2.65	2.10	1.018
3	18672	120.00	80.90	32.80	25.80	2.00	1.65	0.907
4	18653	120.00	81.00	37.00	26.50	2.95	2.00	1.335
5	18657	120.00	82.00	32.70	25.50	2.40	2.20	1.097
6	18651	121.00	81.00	33.50	27.00	2.65	2.00	1.172
7	18684	121.00	81.80	32.30	26.00	2.20	1.80	0.966
8	18683	121.00	81.80	32.30	26.75	2.70	2.15	1.179
9	18674	125.30	82.80	37.00	34.50	3.45	2.95	1.748
10	18671	125.50	84.30	34.50	28.00	2.70	2.50	1.293
11	18648	126.50	84.00	36.50	35.00	3.10	2.70	1.598
12	18678	127.00	83.00	37.00	34.00	2.90	2.35	1.504
13	18676	127.00	84.00	36.50	33.00	2.45	2.60	1.424
14	18682	138.00	97.70	34.50	27.00	2.20	1.80	1.127
15	18681	138.40	98.20	33.80	26.90	2.70	2.20	1.309
16	18680	141.50	97.10	36.80	34.50	2.90	2.50	1.612
17	18649	140.00	98.50	35.00	27.00	2.55	2.40	1.328
18	18652	140.00	98.00	35.00	28.20	2.95	2.70	1.524
19	18656	140.00	98.50	31.70	27.00	2.50	2.30	1.252
20	18647	141.00	98.40	38.40	38.10	3.10	2.70	1.815
21	18673	142.00	98.00	35.00	38.50	3.60	3.60	2.051
22	18650	142.40	98.40	38.40	38.80	3.10	2.80	1.837
23	18677	145.00	98.00	36.50	33.00	2.95	3.00	1.664

HANDLE SECTIONS

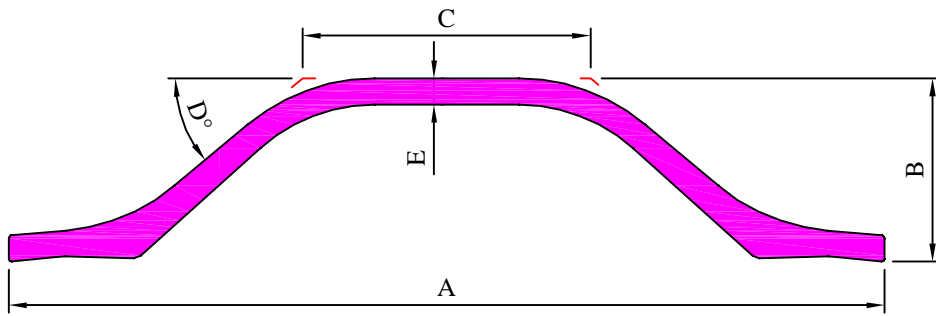

SL. No.	Section No.	A	B	C	D	E	Weight kg/m
1	18663	133.80	28.00	44.00	40.00	4.00	1.742
2	18664	154.50	27.30	64.00	38.50	4.10	2.031

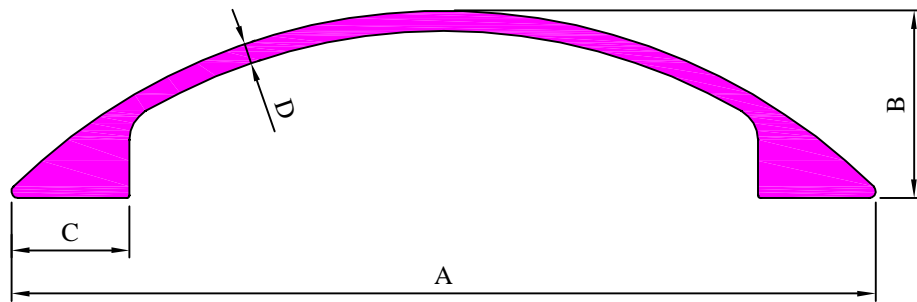

SL. No.	Section No.	A	B	C	D	Weight kg/m
1	18665	132.00	28.60	18.00	3.10	1.724
2	18666	151.80	29.00	18.30	3.20	1.855

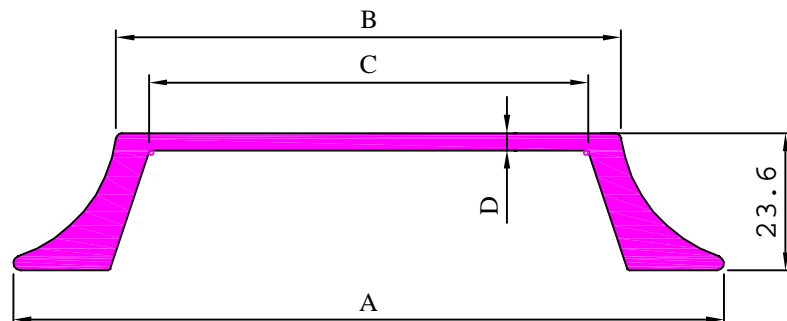

SL. No.	Section No.	A	B	C	D	Weight kg/m
1	18667	122.15	86.80	75.50	3.00	1.748
2	18668	150.75	114.00	102.60	3.20	2.063

HANDLE SECTIONS

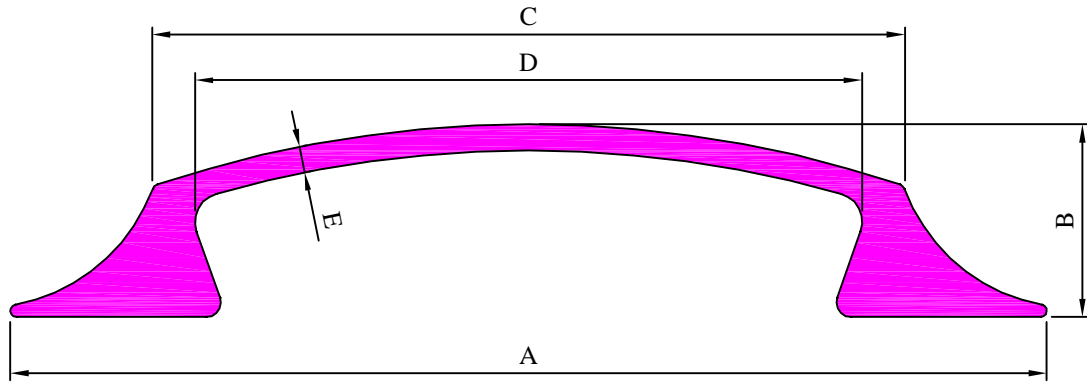

SL. No.	Section No.	A	B	C	D	E	Weight kg/m
1	18669	142.50	26.50	103.50	91.70	3.60	2.340
2	18670	164.25	28.00	128.70	111.50	3.50	2.771

G101125

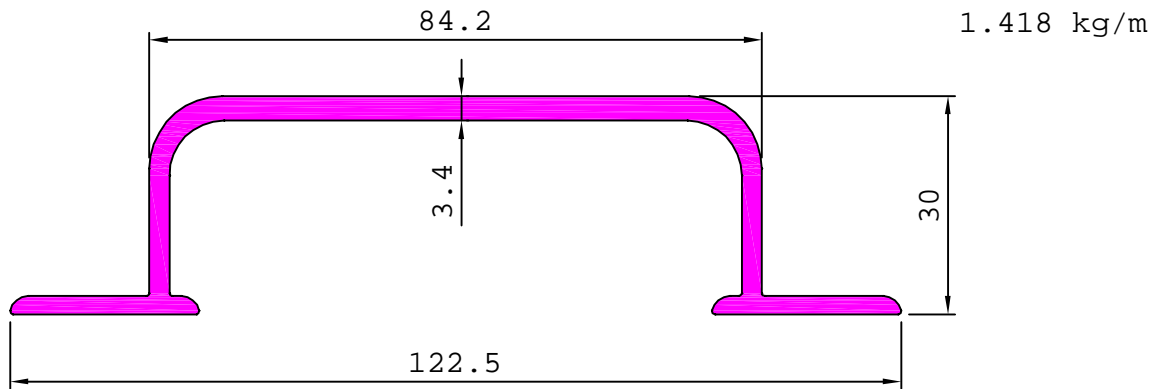

G101126

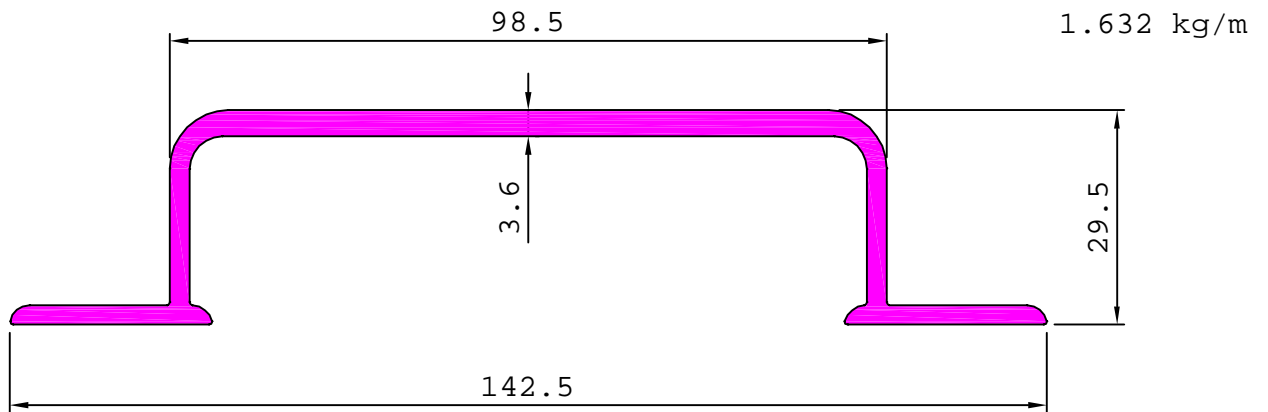

HANDLE SECTIONS

18646

1.579 kg/m

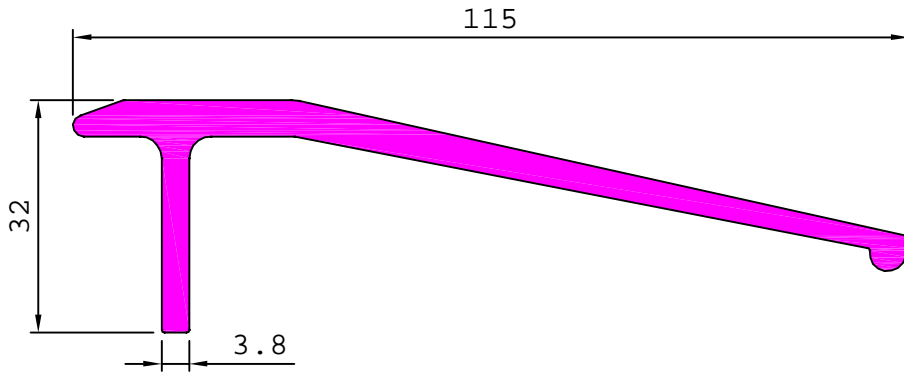

18658

1.411 kg/m

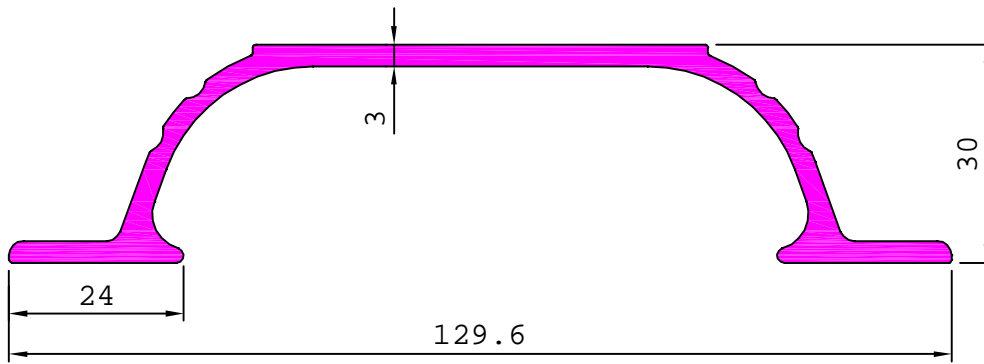

18659

1.613 kg/m

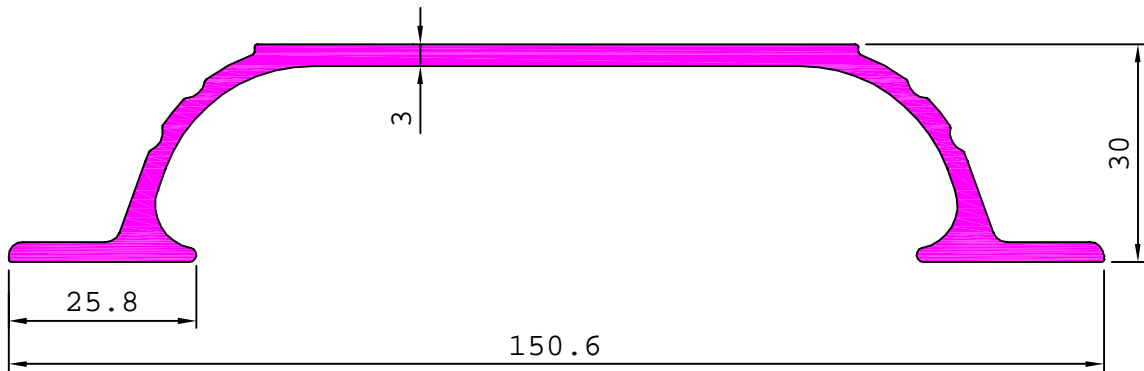

18679

4.240 kg/m

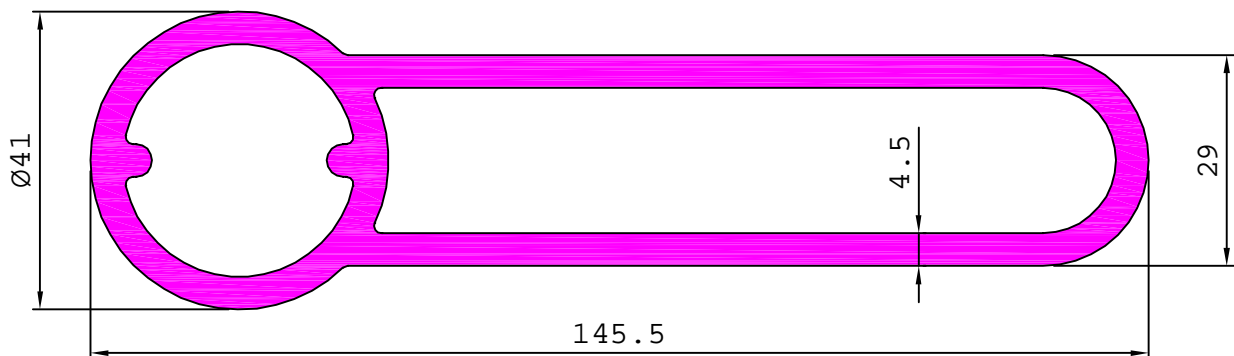

HANDLE SECTIONS

18560 1.709 kg/m

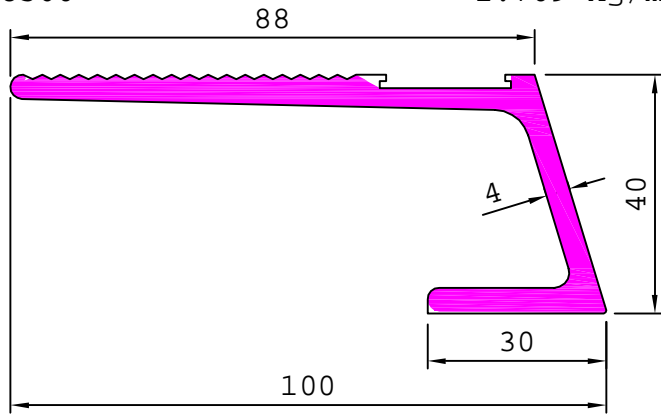

18570 0.942 kg/m

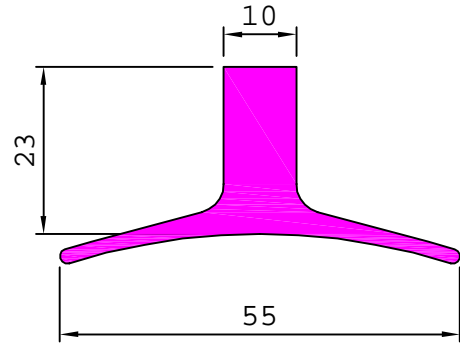

18576 1.074 kg/m

